

788 LINDQUIST STREET LEOLA SD 57456

<https://jarkrealestate.com>

\$ 30,000

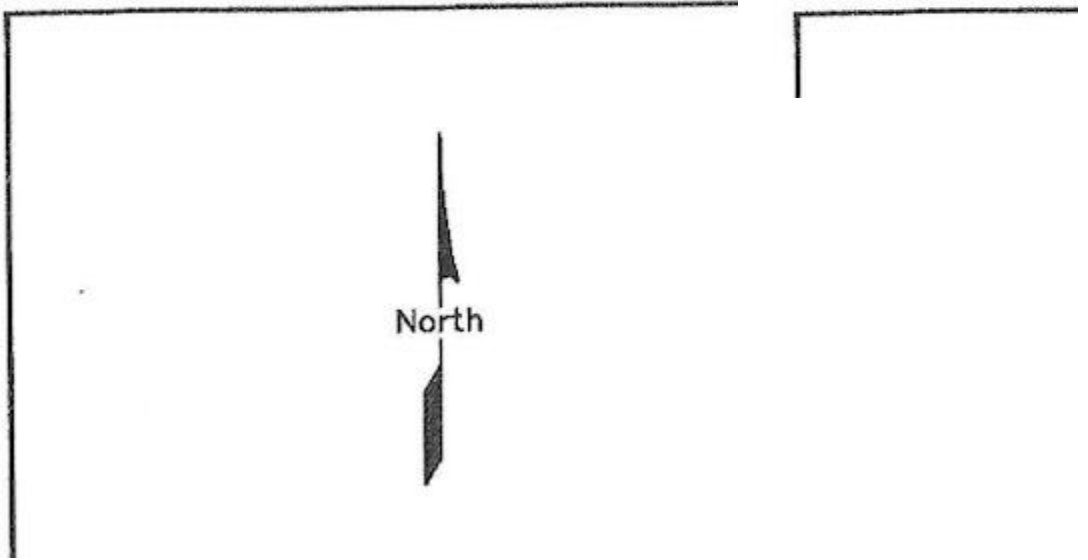

- Land
- Active



CALL US NOW

Phone: 605-725-2228

Email: office@jarkrealestate.com

Address: 221 S 1st Street Aberdeen, SD



BASIC FACTS

MLS #: 25-799

Date added: 10/18/25

Post Updated: 2025-12-01 05:43:31

Type: Land

Status: Active

Lot Size: .85 Acres

Lot Acres: 0.85

PROPERTY DETAILS

Public Remarks: Welcome to Pudwill Lakeside Estates Second Addition, where peaceful living meets the beauty of lakeside life. These spacious lots offer the perfect setting for your dream home or relaxing vacation retreat -- a place where you can unwind, recharge, and reconnect with nature. Wake up to breathtaking sunrises and end your day with unforgettable sunsets over the water. Whether you love fishing, kayaking, bird watching, or simply enjoying a quiet evening outdoors, this area provides endless opportunities for recreation and reflection. You'll appreciate the balance of small-town charm and natural serenity. Here, the neighbors wave, the stars shine brighter, and every day feels a little like vacation.

Area Desc: Area Town

Possession: Close Of Escrow

FEES&TAXES

Taxes: \$ 0



CALL US NOW

Phone: 605-725-2228

Email: office@jarkrealestate.com

Address: 221 S 1st Street Aberdeen, SD

