

2214 S LAWSON STREET, ABERDEEN, SD 57401

<https://jarkrealestate.com>



Great value in a great area! Owner has done a wonderful job of meticulously keeping care of this property! Starting with a new paver patio entry way. The attention to detail can be seen throughout. Fenced in yard, Irrigation, Heated and Insulated Garage, along with a Water Softener and Reverse Osmosis system to give you [...]



Jason Dingman

Dakota Plains Real Estate & Development

- 4 beds
- 2 baths
- Single Family Residence
- Residential
- Active
- 1040 sq ft

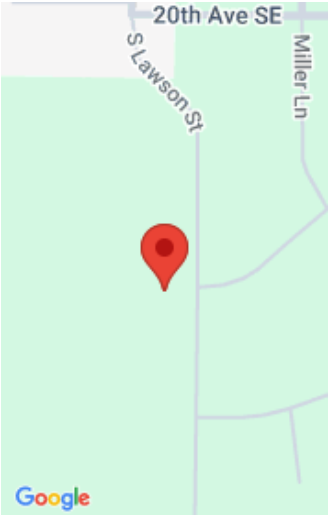

Basics

Category: Residential

Status: Active

Bathrooms: 2 baths

Year built: 2016

County: Brown

Type: Single Family Residence

Bedrooms: 4 beds

Area: 1040 sq ft

Zoning: R-3

Building Details

Building Area Total: 2080 sq ft

Heating: Forced Air, Electric

Foundation Details: Poured

Sewer: Not Shared, Public Sewer

Roof: Composition

Basement: Full, Garden Level

Amenities & Features

Association Amenities: Wdw Appts

Appliances: Dishwasher, Dryer, Microwave, Range, Washer, Water Softener

Cooling: Central Air

WaterSource: Public

Interior Features: Vaulted Ceiling(s)

Courtesy of

List Office Name: Dakota Plains Real Estate & Development

