

1317 THOMAS DRIVE ABERDEEN SD 57401

<https://jarkrealestate.com>

\$ 42,500

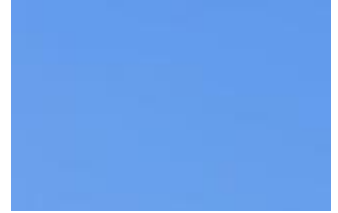
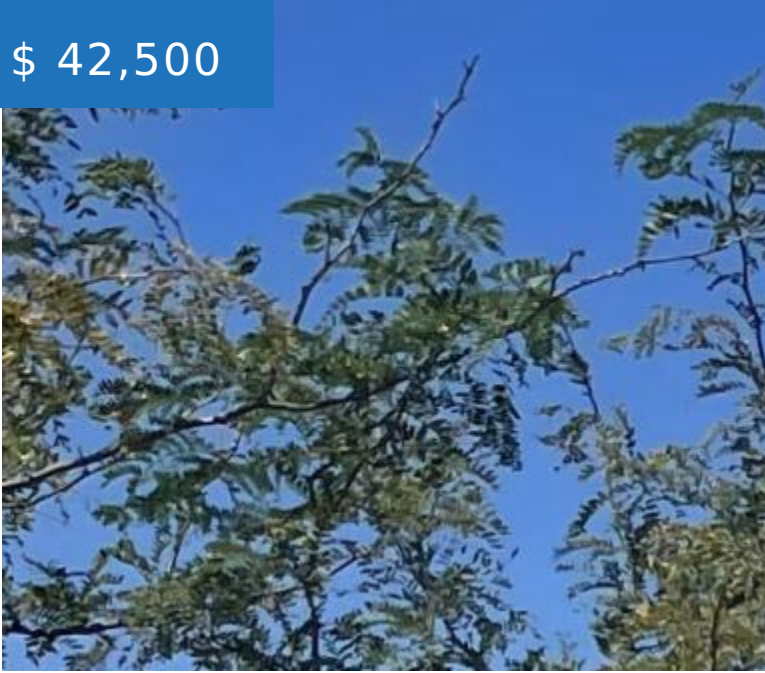

- Land
- Land/Lots
- Active

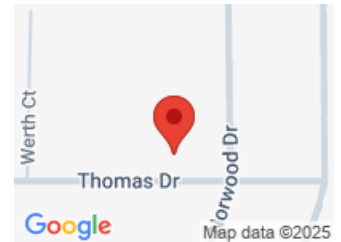

CALL US NOW

Phone: 605-725-2228

Email: office@jarkrealestate.com

Address: 221 S 1st Street Aberdeen, SD



BASIC FACTS

MLS #: 25-623

Date added: 08/27/25

Post Updated: 2025-08-27 21:41:09

Type: Land

Status: Active

Lot Size: 105.23x120

Lot Acres: 0.28

PROPERTY DETAILS

Public Remarks: Excellent building lot in NE

Area Desc: Aberdeen - City

Aberdeen, South facing with a protected view in the rear to enjoy wildlife in the regulated wetland. Wetland in the rear was designed by a landscape architect with specific grasses and an island. Detailed engineering in place to control water level in the wetland.Mound on the property is black dirt that can be spread upon completion of new build.

Platted: Yes

Access: City street frontage

Possession: Close Of Escrow

Survey: Yes

PROPERTY FEATURES

Gas: Available

Flood Plain: No

Utilities: Assessments: None

Utilities: Covenants: Attached

Utilities: Sign: Yes

Utilities: Sewer: City

Utilities: Water: City

FEES&TAXES



CALL US NOW

Phone: 605-725-2228

Email: office@jarkrealestate.com

Address: 221 S 1st Street Aberdeen, SD



Taxes: \$ 654

Tax Year: 2024



CALL US NOW

Phone: 605-725-2228

Email: office@jarkrealestate.com

Address: 221 S 1st Street Aberdeen, SD

